

Best

Saniflo MARINE RANGE



Pumped Electric, Macerator Toilet

To adapt to the ever-more luxurious needs of the pleasure boat market, **SANIMARIN** has developed the 'BEST' Marine Toilet. Aside from the large domestic size bowl, removable soft close seat and lid and contemporary modern design, this toilet also offers a new, more powerful flushing system. Available in 12v or 24v this **BEST** toilet offers a full SFA keypad with 2 flushing cycles, as well as an "empty" function to empty the tank in choppy seas. The **BEST** toilet is now **SANIMARIN**'s top of the range toilet, satisfying both legitimate needs for modernity thanks to a modern design and the permanent quest for comfort on board.

- Minimal Routine Maintenance
- Easy to Clean
- Very Quiet
- 2 Year Guarantee

Technical Specifications

| | | |
|-----------------------|---------------|--------------|
| Water Consumption | 1.2 to 2.4L | |
| Water Pressure | 20 - 45 PSI | |
| Water Connection | ¾" BSP | |
| Waste Outlet | 1" or 1½" | (25 or 38mm) |
| Electric Consumption: | 12 Volt | 25 Amps |
| | 24 Volt | 15 Amps |
| Start-up-surge: | 12 Volt | 133 Amps |
| | 24 Volt | 69 Amps |
| | 12 Volt Motor | 300 Watts |
| | 24 Volt Motor | 360 Watts |
| Weight | 30Kg | |

Dimensions

| A | B | C | D | E | F | G |
|-----|-----|-----|-----|-----|-----|-----|
| 555 | 365 | 467 | 265 | 430 | 490 | 264 |

Dimensions in mm

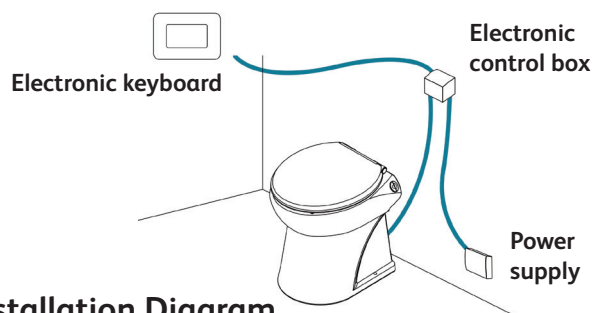
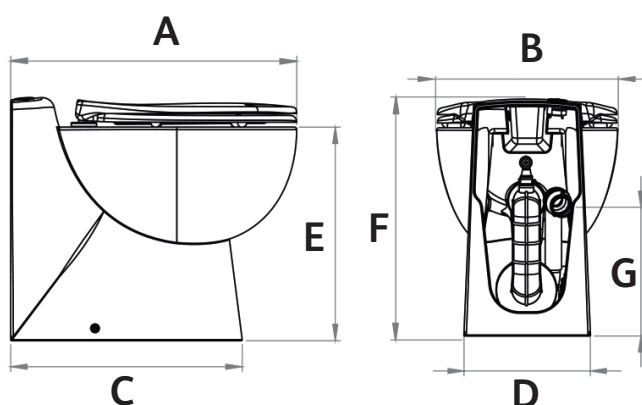

Installation Diagram