

SN41

Saniflo MARINE RANGE



Pumped Electric, Macerator Toilet

To adapt to the ever-more luxurious needs of the pleasure boat market, **SANIMARIN** has developed the 'SN41' Marine Toilet. Aside from the domestic size bowl, removable soft close seat and lid and traditional design, this toilet also offers a new, more powerful flushing system. Available in 12v or 24v this **SN41** toilet offers a full SFA keypad with 2 flushing cycles, as well as an "empty" function to empty the tank in choppy seas. The **SN41** toilet is now **SANIMARIN's** most compact standard height toilet, satisfying both legitimate needs for space saving whilst not compromising on efficiency and the permanent quest for comfort on board.

- Minimal Routine Maintenance
- Easy to Clean
- Very Quiet
- 2 Year Guarantee

Technical Specifications

Water Consumption	1.2 to 2.4L	
Water Pressure	20 - 45 PSI	
Water Connection	¾" BSP	
Waste Outlet	1" or 1½"	(25 or 38mm)
Electric Consumption:	12 Volt	25 Amps
	24 Volt	15 Amps
Start-up-surge:	12 Volt	133 Amps
	24 Volt	69 Amps
	12 Volt Motor	300 Watts
	24 Volt Motor	360 Watts
Weight	26Kg	

Dimensions

A	B	C	D	E
368	496	280	391	411

Dimensions in mm

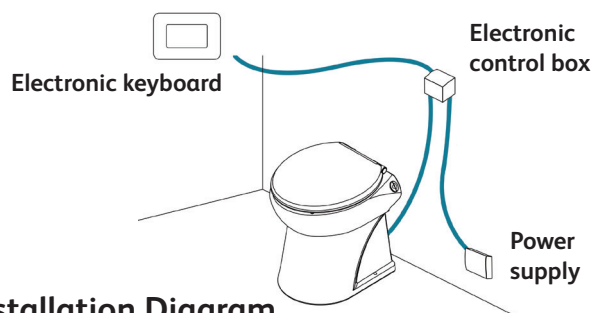
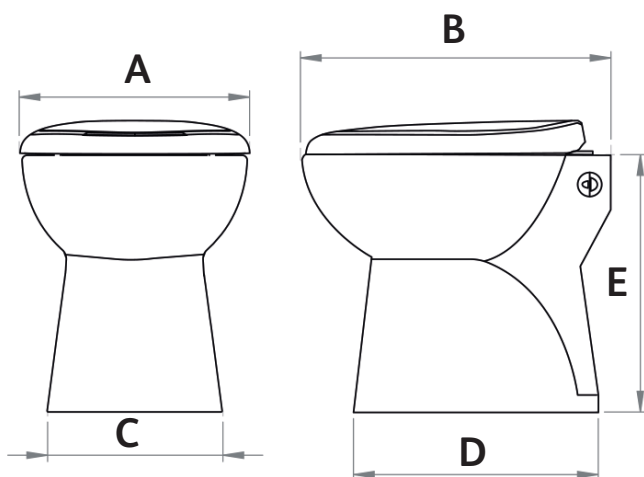

Installation Diagram